

DYNAMc[®] 28 EP SIDEWALL

Sidewall Fusion Capability for Branch Saddles



DynaMc 28 Sidewall with
DynaMc EP HPU

OVERVIEW

The DynaMc[®] 28 EP Sidewall is a small, versatile sidewall fusion machine. The one-jaw and tailstock fusion carriage helps in fusing branch saddles with a maximum base diameter of 9.63 inches (245mm).

The 28 EP Sidewall carriage is lightweight for easy transportation to and from the jobsite. Eyelets on the top of the carriage have been incorporated for easier lifting and lowering into the ditch for work.

The DynaMc 28 EP Sidewall is powered by McElroy's standard DynaMc Electric Pump HPU. The HPU uses a hydraulic accumulator to maintain fusion pressures and reduce power consumption.

The DynaMc EP HPU also works with DynaMc EP butt fusion machines, as well as the DynaMc 28 EP Compact Vertical fusion machine.

FEATURES

- Lightweight, but with rugged, robust features
- Serrated jaws and inserts keep pipe from slipping during fusion process
- DataLogger[®] compatible
- Incorporated eyelets lowering into ditch

051812

SPECIFICATIONS

SADDLE FUSION CAPACITY

Maximum Fitting Base Diameter:..... 9.63" (245mm)

MODELS

898101:..... 1 Jaw/Tailstock Carriage

WEIGHT

Machine:..... 88 lbs. (40 Kg)

EP HPU MODELS

1272701:..... 120V, 60Hz, 1 Phase Input Voltage Requirement

1272702:..... 208V-240V, 60Hz, 1 Phase Input Voltage Requirement

1272703:..... 220V-240V, 50/60Hz, 1 Phase Input Voltage Requirement

1272704:..... 100V, 50/60Hz, 1 Phase Input Voltage Requirement

EP HPU WEIGHT

Machine:..... 110 lbs. (50 Kg)

EP HPU HYDRAULICS

Pressure:..... 1,500 PSI (103 BAR) Max.

Maximum Pump Flow:..... 41 GPM (1.55 LPM)

EP HPU POWER

Power:..... 2.2 HP, 14 AMP @ 120V / 7 AMP @ 240V

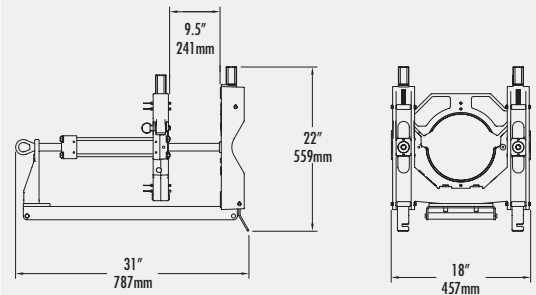

DYNAMC 28 EP SIDEWALL

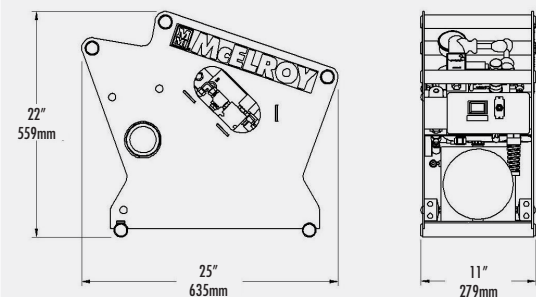

DYNAMC EP HPU

INCLUSIONS

DynaMc 28 EP Sidewall includes fusion carriage. Heater and Electric Pump HPU is sold separately.

Specifications are subject to change without notice.

